

Operation and working

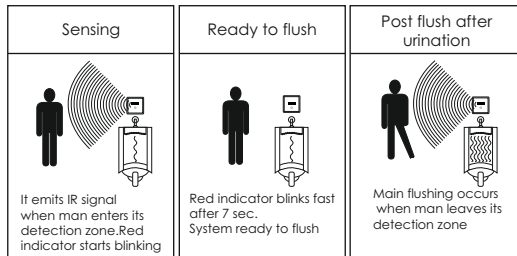

Characteristics:

INTEGRATED SENSORS FOR CERAMIC URINAL POTS
EASILY REPLACEABLE IN ANY BRAND URINAL
powered by 4pcs AA alkaline batteries.
RELIABLE AND FRIENDLY CUSTOMER SERVICE
Always be ready to respond within a 24-hour time frame

CUSTOMER SUPPORT :- Toll Free | 1800 121 6254

AFTER-SALES SERVICE

Our Customer Support Team is comprehensively trained to provide help and advice, spare parts or a service visit.

SPARE PARTS

We maintain an extensive stock of spares and aim to have functional parts available for ten years from the date of final manufacture of the product. Spares can be purchased from approved stockists or merchants (locations on request) or direct from our Customer Support Department. Spares direct will normally be dispatched within two working days.

NOTE

In the interest of safety, spares requiring exposure to mains voltages can only be sent to qualified persons.

SERVICE

Our Customer Support Team is available to provide quality service at a reasonable cost. You will be assured of the services of a trained engineer / agent, genuine spares and a 3-month warranty on the repair.

Bharat Photon®
bringing India to the world...



Intelligent
sensor flushes
automatically

BP-U522M
Battery Operated
In-built Model for Urinals

Installation Manual

Step By Step Installation Guide

- STEP 1:** Clean the pipeline by running 1~2 bucket water until dust particles like cement pieces or thread etc. are washed away.
- STEP 2:** Unscrew the front plate with back plate and install it in Urinal window.
- STEP 3:** Tighten the back plate after installing with nuts so that sensor plate holds the urinal.
- STEP 4:** Now install the water pipeline to the solenoid valve given in the box and connect the outlet to the urinal pot outlet.
- STEP 5:** Install 4 XAA size Alkaline batteries into battery compartment & connect the terminal from the sensor to the battery pack
- STEP 6:** Connect the other terminal from the sensor to the solenoid valve terminal.

Note : An adjustment pot is provided in circuit box for adjustment of sensing range (by default, the settings are at optimum value, change only if required at this site)

INDICATORS -1. Red Blinking Slow -Sensing ON
2. Red Blinking Fast - Ready for flush

STEP 6 : Place the battery pack inside the urinal at proper place

Your Battery Operated Auto Flush Sensor for Urinal is ready for use now!
For Cleaning of valve (If Water Flow is minimised or very less): Open the inlet of the solenoid valve and take out the filter net from the valve by a plyer.
Clean & refit the filter net & the valve.

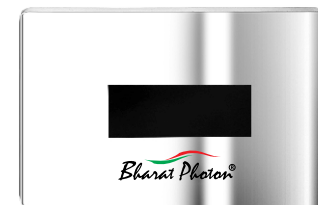

BP-U522M
(Polished chrome brass)

NOTE : Red blinking indicator is for sensing which must be done for 7-8 seconds continuously in order to lock operation.

A PRODUCT PROUDLY DESIGNED & MANUFACTURED IN INDIA